

ADJUSTING INSTRUCTIONS FOR THE TIE ROD ADJUSTING PIECE OF LATER DESIGN FOR THE FSDP-09/10 AND SSDP-10/12 DRIVE STEER AXLES

Change: The Tie Rod Adjusting design (B) has been used in production since May 1999. In this design there is no locking screw in the adjusting piece itself. Instead, the adjusting piece is partly split so that when the screws in the tie rod are tightening, the adjusting piece is also tightened. Because the locking efficiency depends on the position of the adjusting piece, this adjusting procedure is very important.

From April 2000 the earlier adjusting design (A) with separate locking screws is standard in axle production again.

Part numbers:

Description	Design A: Adjusting Piece with lock screw	Design B: Adjusting Piece without lock screw
Adjusting Piece	095-130-2031	595-130-2051
Screw M14x70	90301-14703	
Nut M14	90550-14227	

Interchangeability: The Adjusting Pieces are totally interchangeable.

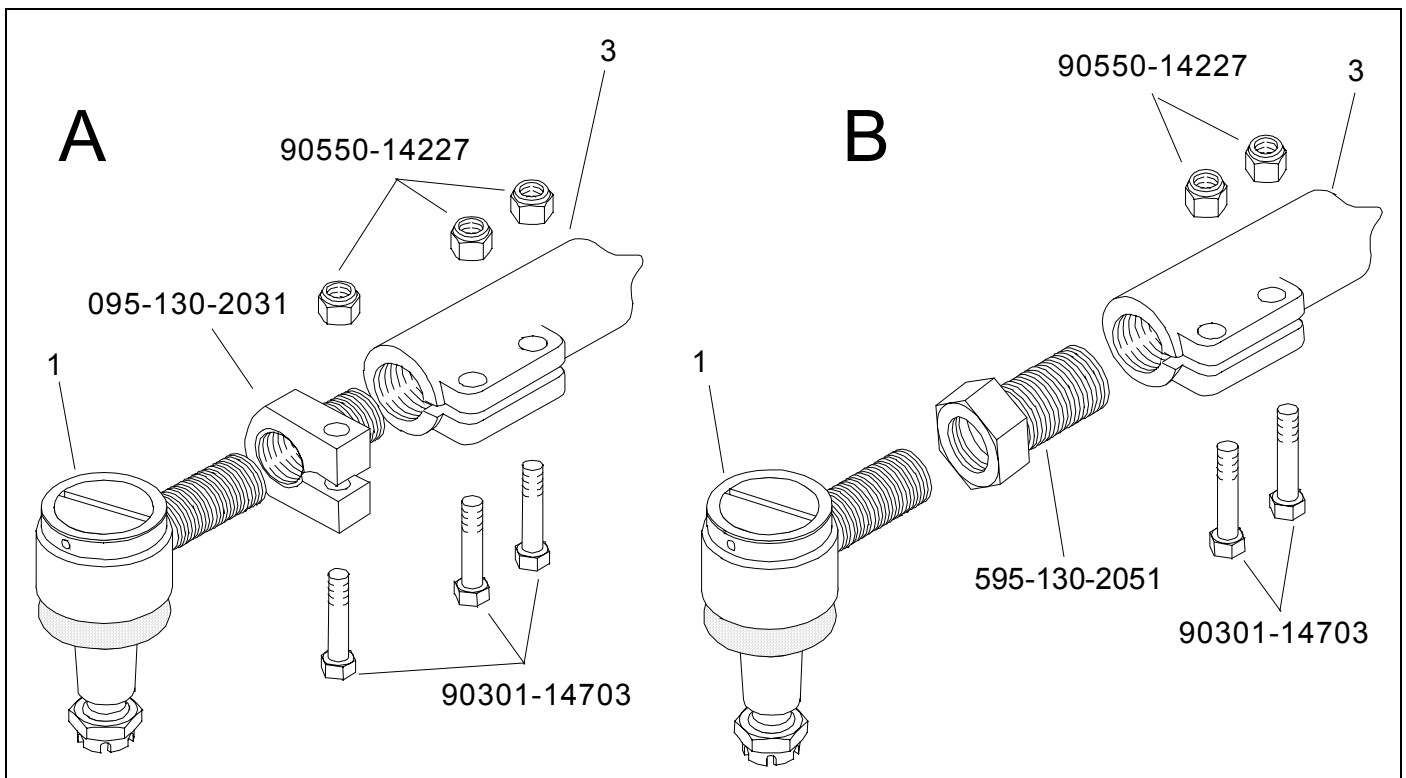

Picture 1.

**Adjusting
Instructions:**

When adjusting the toe-in, the split in the adjusting piece should be left in the section marked in picture 2, which ensures that the locking screws also tighten the adjusting piece and the ball joint assembly in place.

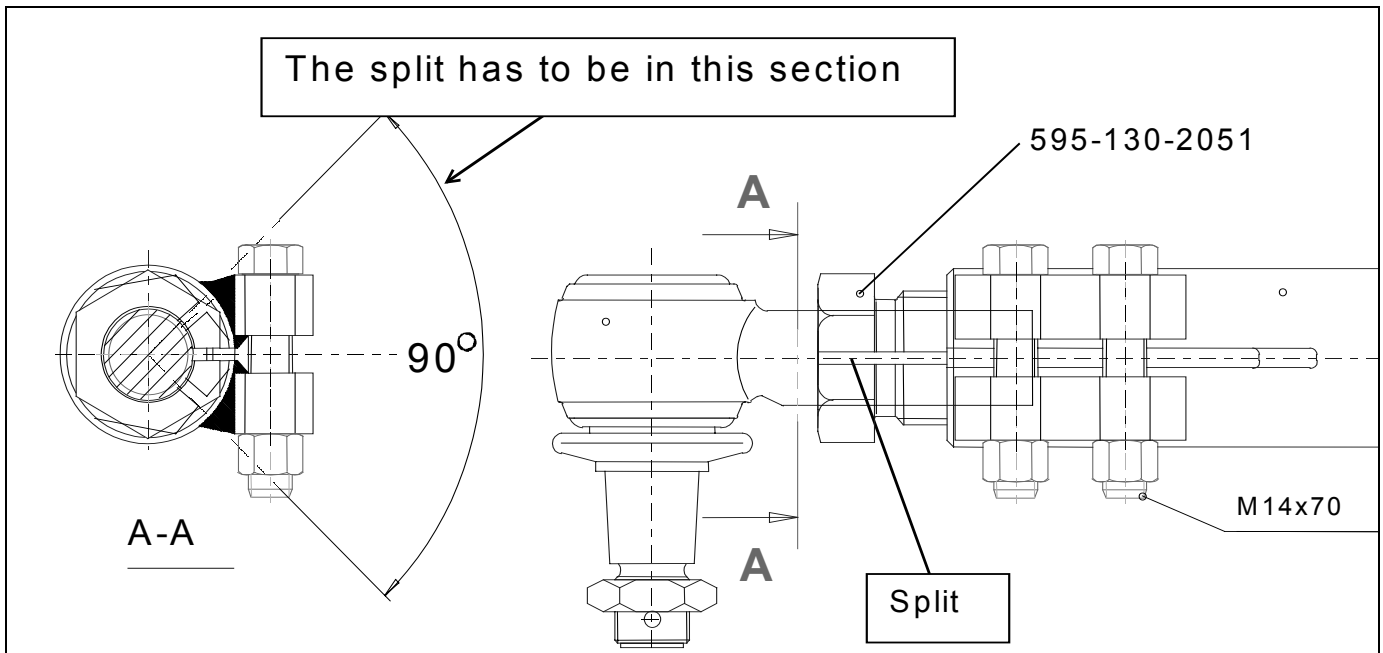

Picture 2.