

**HIGH SPEED, (TRUCK) DRIVE STEER TANDEM AXLE, FS2P28G**

|   |   |
|---|---|
| <b>GAWR</b>   | 28 000 kg [62,000 Lb.]  |
| <b>GCWR</b>   | 150 000 kg [330,000 Lb.]  |
| <b>Axle Type</b>                                    | Spiral Bevel Center Differential<br>Planetary Wheel End Reduction, 5-planet Carrier                   |
| <b>Brakes</b>                                       |   |
| Type  | Wedge Duplex  |
| Size  | Ø410 mm [16,1 Inch] x 200 mm [7,9 Inch]   |
| Chamber   | 18 Square Inch  |
| Certification                                       | FMVSS 121   |
| <b>Steering</b>                                     |   |
| KPI   | 8°  |
| Caster  | 2°  |
| Camber  | 0°  |
| Turn angle  | 42°   |
| <b>Housing</b>                                      | Fabricated Steel, Cross Section 153 mm [6,0 Inch] Height<br>x 137 mm [5,4 Inch] Width, Center Bowl    |
| <b>Wheel End</b>                                    | 10-studs on 335 mm[13,2 Inch] BC, 280.8 [11,06 Inch] mm<br>Pilot Diameter. Minimum Wheel Size 20 Inch |
| <b>Wheel offset</b> (optimal)                       | Inset 130...165 mm [5.1...6.5 Inch]   |
| <b>Drive Flange</b>                                 | ISO8667-T180  |
| <b>Final Drive Ratios</b>                           | 6.36, 7.01 and 8.79   |
| <b>Tracks Available</b> (Over wheel mounting faces) | 2360 mm [92.9 Inch] or 2580 mm [101.6 Inch]   |
| <b>Lubrication</b>                                  |   |
| Type  | API GL-5  |
| Capacity (FSDP14G)                                  | Total 21 liters [44 pints]  |
| Capacity (FSMP14G)                                  | Total 27 liters [57 pints]  |
| <b>Weight-Dry</b> (for Track 2360 mm)               |   |
| FSDP14G   | 915 kg [2,017 Lb.]  |
| FSMP14G   | 1025 kg [2,260 Lb.]   |

---

All ratings are nominal. Actual capacities determined based upon review of application data by Sisu Axles Inc.

|                 |                              |                             |
|-----------------|------------------------------|-----------------------------|
| <b>OPTIONS:</b> | Spring Seats                 | Wheel Stud Length           |
|                 | Wheel Nuts                   | Brake Chambers              |
|                 | Input / Output drive flanges | Axle Differential Lock      |
|                 | ABS Provision                | Steering Arm Configurations |
|                 | CTI Provision                | Top Coating                 |

---

Other options may be available. Contact Sisu Axles sales for more information.

---

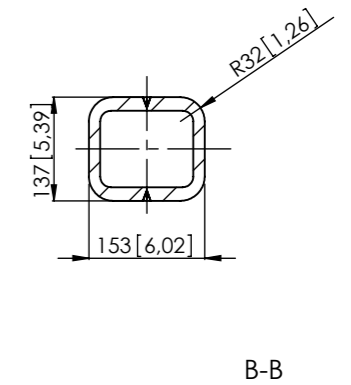
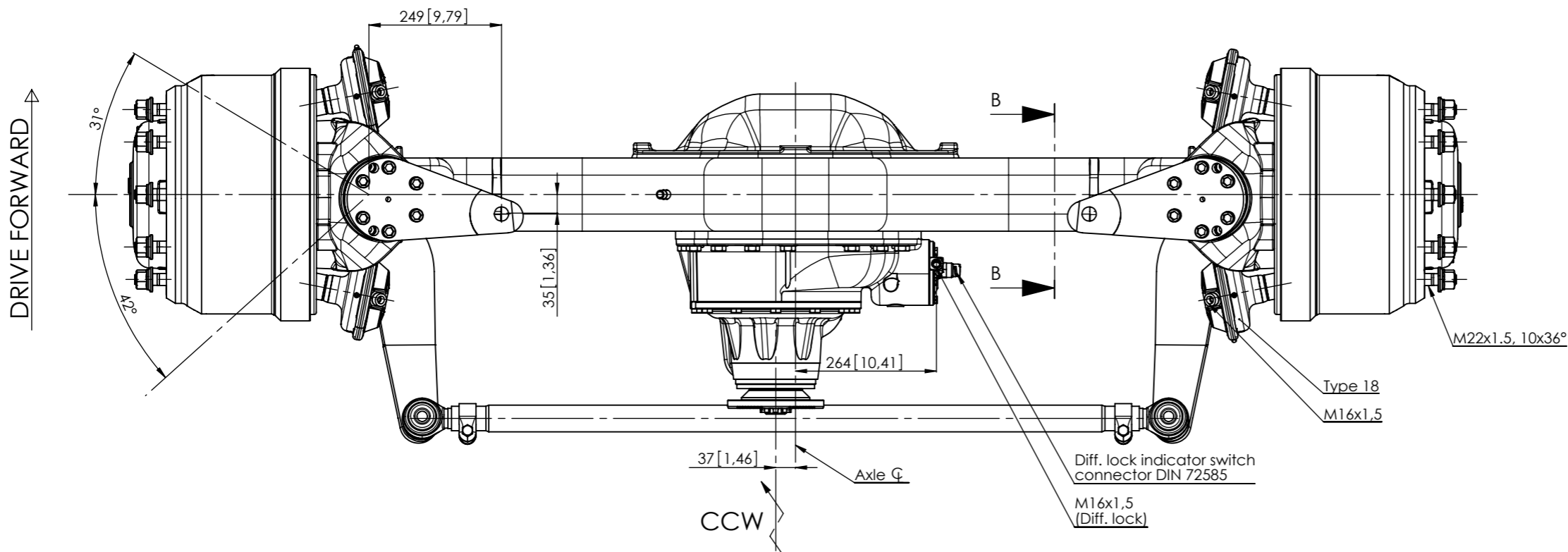
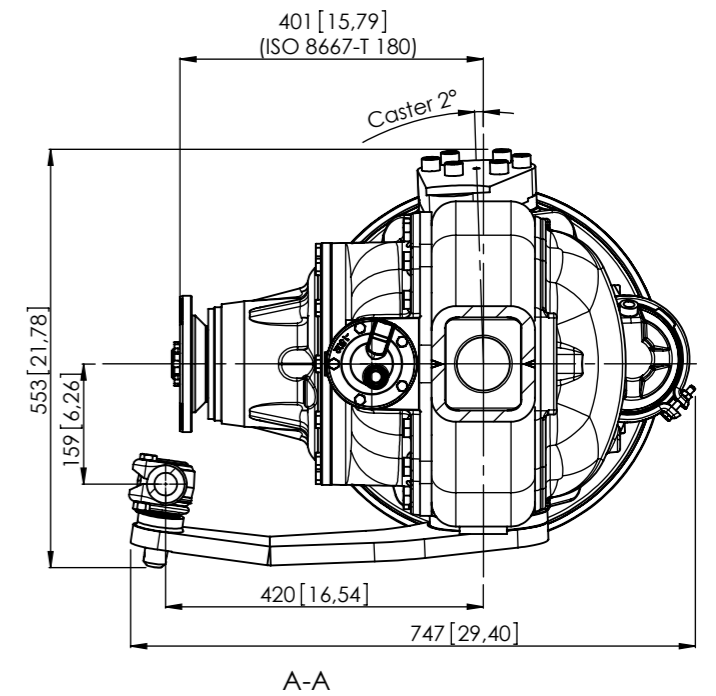
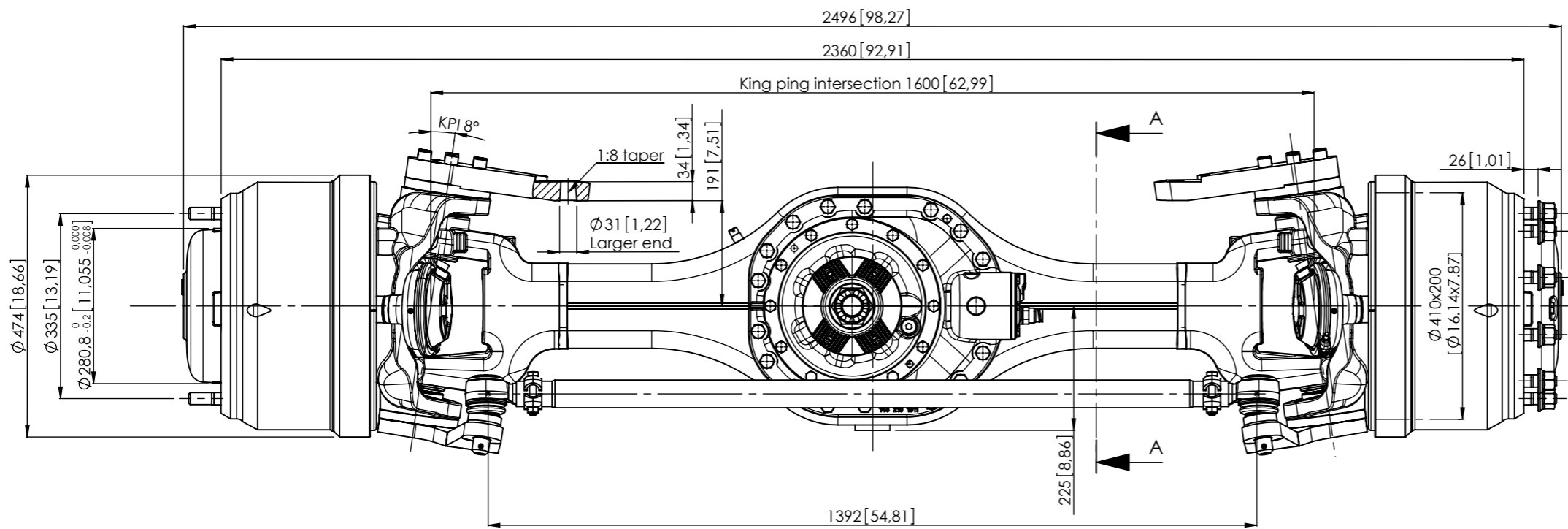

|  |  |                              |  |                   |  |              |  |
|--|--|------------------------------|--|-------------------|--|--------------|--|
|  |  | Scale                        |  | Material          |  | Product      |  |
|  |  | 1:10<br>DO NOT SCALE DRAWING |  |                   |  | FSDP14G      |  |
| <small>THIS DRAWING AND THE INFORMATION CONTAINED HEREIN IS PROPRIETARY TO SISU AXLES INC. IT SHALL NOT BE REPRODUCED, COPIED OR DISCLOSED IN WHOLE OR IN PART, OR USED FOR MANUFACTURE OF FOR OTHER PURPOSE WITHOUT THE WRITTEN PERMISSION OF SISU AXLES INC.</small> |  | Drawn                        |  | Date              |  | Approved     |  |
|  |  | JALI                         |  | 11.04.2007        |  |              |  |
|  |  | Dimensions                   |  | Title             |  | Weight       |  |
|  |  | mm                           |  | Dimension drawing |  | kg           |  |
|  |  |                              |  | Steering          |  |              |  |
|  |  |                              |  | Drive             |  |              |  |
|  |  |                              |  | Drawing n:o       |  | Rev.         |  |
|  |  |                              |  | M541-040-0028     |  | A            |  |
|  |  |                              |  |                   |  | Sheet        |  |
|  |  |                              |  |                   |  | 1/1          |  |
|  |  |                              |  |                   |  | Drawing size |  |
|  |  |                              |  |                   |  | A3           |  |

|      |                     |         |              |          |               |
|------|---------------------|---------|--------------|----------|---------------|
| A    | Modeled and redrawn | NIAH    | 15.04.2010   | JALI     | 12.05.2010    |
| REV. | DESCRIPTION         | CHANGED | CHANGED DATE | APPROVED | APPROVED DATE |

